

1300 SERIES STANDARD LIQUID FILLABLE GAUGE WITH CRIMPED RING MODEL:1300



Applications:

1300 series pressure gauge is for industrial applications where the media or the environment contains chemically aggressive substances. The gauge is filled with liquid for dampen mechanical vibrations.

Specifications:

Nominal sizes:

1.5", 2", 2.5", 3", 4"

Accuracy class:

1.5", 2" :KL 2.5

3", 2.5", 4" :KL 1.6

Connection:

BSP 1/8" for 1.5"

BSP 1/4" for 2", 2.5", 3"

BSP 1/2" for 4"

Scale Range, according to EN 837-1/5

Pressure ranges: 0 to 0.6/1/1.6/2.5/4/6/10/16/25/40/60/100/160/250/400/600/1000 bar

Vacuum range: -1 to 0 bar

Compound pressure: -1 to 0.6/1.5/3/5/9/15/24 bar

Operating Temperature:

Ambient: -40°C to 60°C, medium: 200°C maximum

Material Specification:

Case : 304 stainless steel case and crimped ring Window: polycarbonate

Wetted parts: 316 stainless steel bourdon tube and connection,

Movement: 304 stainless steel

Standard filling: glycerin

Options:

NPT, BSPT or other process connection

Restrictor

Double dial range or other dial ranges

Silicone oil filling

Refrigeration scale

DIMENSION:

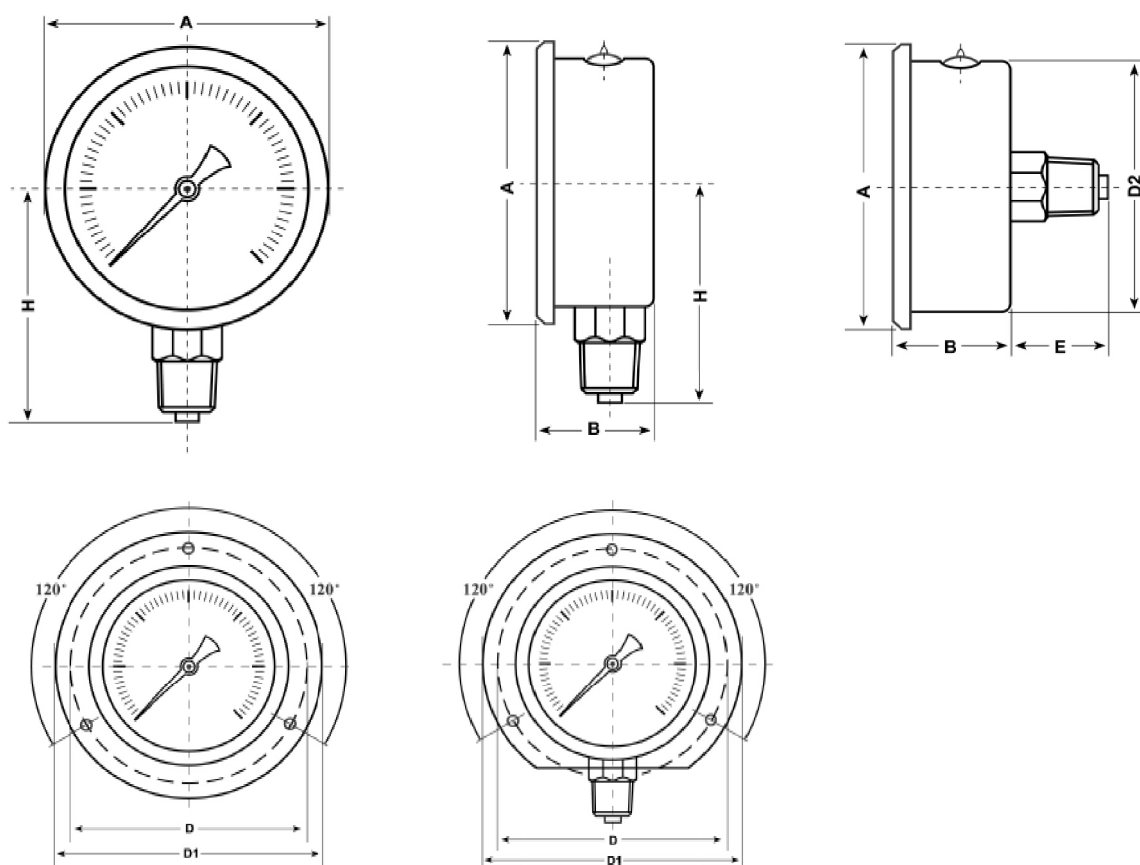

DIAL SIZE	D	B	H	E	D	D1	D2
1.5"	Ø46.8	24.7	44.5	19	--	--	--
2"	Ø59.3	29.7	49.5	25	--	--	--
2.5"	Ø68	29.8	54.5	25	74	88	62
3"	Ø83	35	62	33	99	105	75
4"	Ø109	35.5	74	33	118	131	98

dimensions are approximate and can be changed without prior notice