

1700 SERIES MAGNETIC SNAP-ON CONTACT PRESSURE GAUGE MODEL:1700



Applications:

1700 series magnetic snap-on contact gauge is designed for automatic control and signals transfer. When the pressure gets to the set value, the contact opens/closes the circuits. It has a magnetic electric contact.

Specifications:

Nominal sizes:

2.5", 4", 6"

Connection:

BSP 1/4" for 2.5"

BSP 1/2" for 4", 6"

Protection class: IP 54

Scale Range, according to EN 837-1/5

Pressure ranges: 0 to 0.6/1/1.6/2.5/4/6/10/16/25/40/60/100/160/250/400bar

Vacuum range: -1 to 0 bar

Compound pressure: -1 to 0.6/1.5/3/5/9/15/24 bar

Operating Temperature:

Ambient: -20°C to 60°C, medium: 60°C maximum

Material Specification:

Case : black steel case and bezel

Window: high polycarbonate

Wetted parts: brass bourdon tube and connection

Movement: brass

Contacts: Two contacts, one contact, Often open, often close

Maximum working voltage: AC380V or DC220V

Maximum current: 1A

Contact Power: 30VA

Options:

NPT, BSPT or other process connection

Non-standard dial range

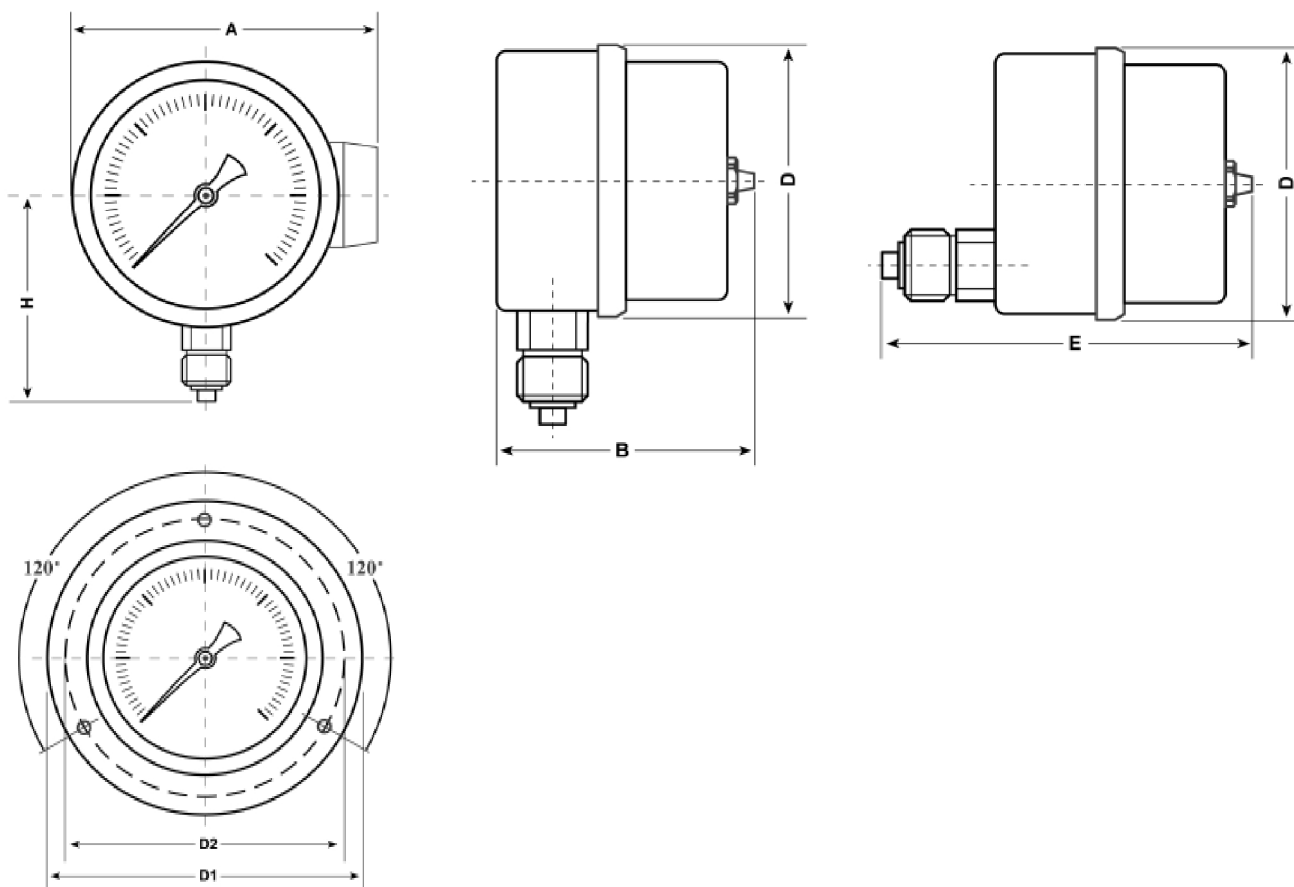

| DIAL SIZE | A | B | D | H | D1 | D2 | E |
|-----------|-------|----|-----|-----|------|------|-----|
| 2.5" | 75 | 55 | 60 | 55 | -- | -- | -- |
| 4" | 122 | 88 | 102 | 92 | Ø130 | Ø116 | 135 |
| 6" | 168.5 | 87 | 150 | 120 | Ø178 | Ø166 | 142 |

dimensions are approximate and can be changed without prior notice