

## DCS200 SERIES DIAPHRAGM CHEMICAL SEALS, FLANGEN END MODEL:DCS200



### Applications:

DCS200 is designed to isolate the sensing element of pressure gauges from process fluids that may be corrosive, viscous, sedimentous and/or with high temperature.

DCS200 is suitable for pressure from -1 to 25bar with flanged end design.

### Specifications:

#### Instrument connection:

Capillary, 1/4", 1/2" BSP/NPT female

Process connection:

Flange

Process temperature: -45+150°C

Filling liquid: Silicone oil, glycerin, fluorocarbon oil, vegetable oil

Pressure range: -1-0-25bar

### Material:

Gasket: Teflon

Diaphragm: SS 316L, SS316L PTFE coating, SS316L Teflon lined, HC, TI etc

Nuts and bolts: SS 316, SS304

Upper housing: SS 316, SS304

Lower housing and flange: SS 316, SS304

Process and instrument connection: SS 316, SS316L

## DIMENSION:

### DCS200 with ANSI and ISO Flange

#### Table Options for Filling Working Fluid

Working Fluid	Diaphragm Seal Temp. range (°C)	Service	Instrument Normal Oper. Temp (°C)
Silicon (Low Viscidity)	- 40°..130°	General	- 30°..50°
Silicon (High Viscidity)	- 30°..240°	High Temp.	- 20°..60°
Fluorocarbon Oil	- 30°..160°	Salt & Acid	- 20°..50°
Glycerine	- 5° ..100°	Food	- 5° ..40°
Propylene Glycol	- 30°..100°	Food	- 20°..40°

Standard Working Fluid is Silicon (Low Viscidity)

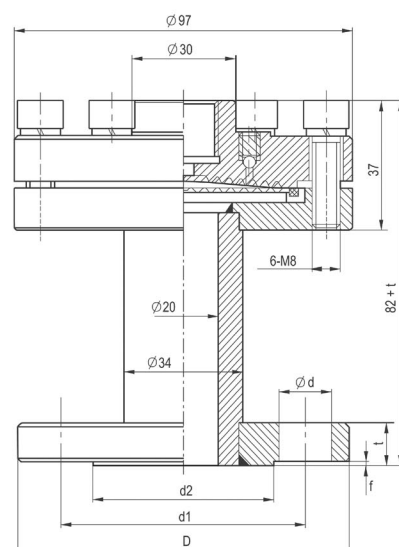

#### Process Flanges according to ASME B16.5 Standard

Size	Rating	D	t	f	d2	d1	d	
							Pcs	Size
½"	150#	88.9	11.2	1.6	35.1	60.5	4	15.7
¾"	150#	98.6	12.7	1.6	42.9	69.9	4	15.7
1"	150#	108.0	14.2	1.6	50.8	79.2	4	15.7
1¼"	150#	117.3	15.7	1.6	63.5	88.9	4	15.7
1½"	150#	127.0	17.5	1.6	73.2	98.6	4	15.7
2"	150#	152.4	19.1	1.6	91.9	120.7	4	19.1
½"	300#	95.2	14.2	1.6	35.1	66.5	4	15.7
¾"	300#	117.3	15.7	1.6	42.9	82.5	4	19.1
1"	300#	123.9	17.5	1.6	50.8	88.9	4	19.1
1¼"	300#	133.3	19.0	1.6	63.5	98.5	4	19.1
1½"	300#	155.4	20.6	1.6	73.2	114.3	4	22.3
2"	300#	165.1	22.4	1.6	91.9	127.0	8	19.1
½"	600#	95.3	20.6	6.4	35.1	66.5	4	15.7
¾"	600#	117.3	22.1	6.4	42.9	82.5	4	19.1
1"	600#	124.0	23.9	6.4	50.8	88.9	4	19.1
1¼"	600#	133.4	27.0	6.4	63.5	98.5	4	19.1
1½"	600#	155.4	28.8	6.4	73.2	114.3	4	22.3
2"	600#	165.1	31.8	6.4	91.9	127.0	8	19.1

#### Process Flanges according to DIN 2501 Standard

DN	PN	D	t	f	d2	d1	d	
							Pcs	Size
15	2.5.6	80	12	2	40	55	4	11
15	10..40	95	16	2	45	65	4	14
20	2.5.6	90	14	2	50	65	4	11
20	10..40	105	18	2	58	75	4	14
25	2.5.6	100	14	2	60	75	4	11
25	10..40	115	18	2	68	85	4	14
32	2.5.6	120	14	2	70	90	4	14
32	10..40	140	18	2	78	100	4	18
40	2.5.6	130	14	3	80	100	4	14
40	10..40	150	18	3	88	110	4	18
50	2.5.6	140	14	3	90	110	4	14
50	10..40	165	20	3	102	125	4	18