

DCS201 SERIES DIAPHRAGM CHEMICAL SEALS, FLAT FLNGEN END MODEL:DCS201



Applications:

DCS201 is designed to isolate the sensing element of pressure gauges from process fluids that may be corrosive, viscous, sedimentous and/or with high temperature. DCS201 is suitable for pressure from -1 to 40 bar with flat flanged end design.

Specifications:

Instrument connection:

Capillary, 1/4", 1/2" BSP/NPT female

Process connection:

Flange

Process temperature: -45+150°C

Filling liquid: Silicone oil, glycerin, fluorocarbon oil, vegetable oil

Pressure range: -1-0-40bar

Material:

Gasket: Teflon

Diaphragm: SS 316L, SS316L PTFE coating, SS316L Teflon lined, HC, TI etc

Nuts and bolts: SS 316, SS304

Upper housing: SS 316, SS304

Lower housing and flange: SS 316, SS304

Process and instrument connection: SS 316, SS316L

DIMENSION:

DCS201 with ANSI and ISO Flange

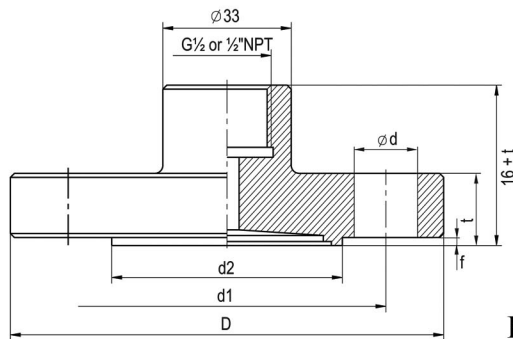

Table Options for Filling Working Fluid

Working Fluid	Diaphragm Seal Temp. range (°C)	Service	Instrument Normal Oper. Temp (°C)
Silicon (Low Viscidity)	- 40°..130°	General	- 30°..50°
Silicon (High Viscidity)	- 30°..240°	High Temp.	- 20°..60°
Fluorocarbon Oil	- 30°..160°	Salt & Acid	- 20°..50°
Glycerine	- 5° ..100°	Food	- 5° ..40°
Propylene Glycol	- 30°..100°	Food	- 20°..40°

Standard Working Fluid is Silicon (Low Viscidity)

Process Flanges according to ASME B16.5 Standard

Size	Class	D	t	f	d2	d1	d		
							Pcs	Size	Weight(kg)
1"	150	108	14.2	1.6	50.8	79.2	4	15.7	1.30
1½"	150	127	17.5	1.6	73.2	98.6	4	15.7	1.50
2"	150	152.4	19.1	1.6	91.9	120.7	4	19.1	2.60
3"	150	190.5	23.9	1.6	127	152.4	4	19.1	5.20
4"	150	228.6	23.9	1.6	157.2	190.5	8	19.1	7.50
1"	300	123.9	17.5	1.6	50.8	88.9	4	19.1	1.60
1½"	300	155.4	20.6	1.6	73.2	114.3	4	22.3	2.40
2"	300	165.1	22.4	1.6	91.9	127.0	8	19.1	3.60
3"	300	209.5	28.4	1.6	127	168.1	4	22.3	7.60
4"	300	254	31.7	1.6	157.2	200.1	8	22.3	12.50
1½"	600	155.4	28.8	6.4	73.2	114.3	4	22.3	3.20
2"	600	165.1	31.8	6.4	91.9	127.0	8	19.1	5.60
3"	600	209.6	38.2	6.4	127	168.1	8	22.3	10.80
4"	600	273.1	44.5	6.4	157.2	215.9	8	25.4	21.30
1½"	1500	177.8	38.1	6.4	73.2	123.9	4	28.4	5.80
2"	1500	215.9	44.5	6.4	91.9	165.1	8	25.4	12.90
3"	1500	266.7	54.1	6.4	127	203.2	8	31.8	24.30
4"	1500	311.1	50.2	6.4	157.2	241.3	8	35.1	36.80
1½"	2500	203.2	50.9	6.4	73.2	146.1	4	31.8	10.25
2"	2500	235	57.2	6.4	91.9	171.5	8	28.4	19.50
3"	2500	304.8	72.9	6.4	127	228.6	8	35.1	42.50
4"	2500	355.6	83.6	6.4	157.2	273.1	8	41.1	65.50

Process Flanges according to DIN 2501 Standard

DN	PN (Bar)	D	t	f	d2	d1	d		
							Pcs	Size	Weight(kg)
25	10..40	115	18	2	68	85	4	14	1.40
25	64..160	140	24	2	68	100	4	18	2.40
40	10..40	150	18	3	88	110	4	18	2.00
40	63..100	170	26	3	88	125	4	22	3.90
40	160	170	28	3	88	125	4	22	4.20
40	250	185	34	3	88	135	4	26	6.20
50	10..40	165	20	3	102	125	4	18	3.20
50	64	180	26	3	102	135	4	22	5.00
50	100	195	28	3	102	145	4	26	6.30
50	160	195	30	3	102	145	4	26	6.80
50	250	200	38	3	102	150	8	26	9.20
80	10..16	200	20	3	138	160	8	18	4.80
80	25..40	200	24	3	138	160	8	18	5.60
80	64	215	28	3	138	170	8	22	7.80
80	100	230	32	3	138	180	8	26	10.20
80	160	230	36	3	138	180	8	26	11.50
80	250	255	46	3	138	200	8	30	18.20
100	10..16	220	20	3	158	180	8	18	5.80
100	25..40	235	24	3	162	190	8	22	8.00
100	64	250	30	3	162	200	8	26	11.30
100	100	265	36	3	162	210	8	30	15.30
100	160	265	40	3	162	210	8	30	17.10
100	250	300	54	3	162	235	8	33	29.70
125	10..16	250	22	3	188	210	8	18	8.20
125	25..40	270	26	3	188	220	8	26	11.50
125	63	295	34	3	188	240	8	30	14.50
125	100	315	40	3	188	250	8	33	24.20
125	160	315	44	3	188	250	8	33	26.80
125	250	340	60	3	188	275	8	33	42.50